

■ DIMENSIONS

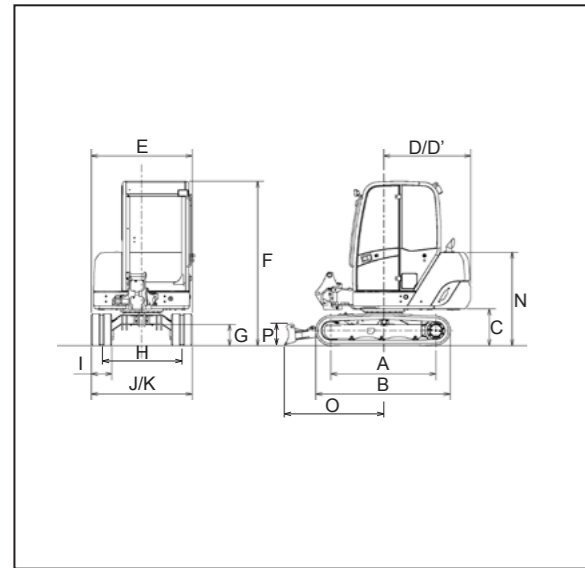

■ WORKING RANGES

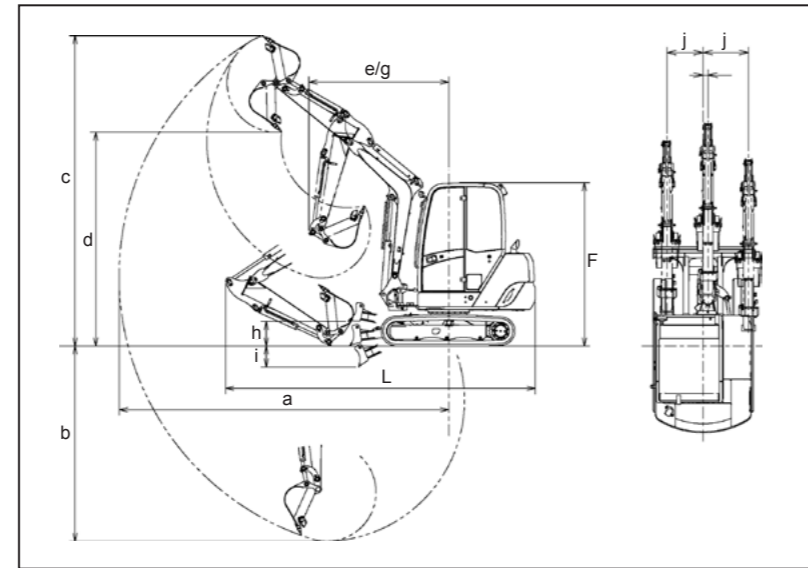

● DIMENSIONS & WORKING RANGES

Item	Model	AX16-4	AX18-4	AX27-4
A: Distance between tumblers	mm	1,110	1,210	1,530
B: Undercarriage length	mm	1,470	1,570	1,960
C: Counterweight clearance	mm	420		538
D: Rear-end swing radius	mm	1,060		1,270
D':Rear-end length	mm	1,060		1,270
E: Overall width of upperstructure	mm	cabin 1,040 / canopy 980		1,400
F: Overall height of cab	mm	cabin 2,380 / canopy 2,340		2,390
G:Min. ground clearance	mm	235	165	300
H: Track gauge	mm	750	740 - 1,050	1,170
I: Track shoe width	mm	230		300
J: Undercarriage width	mm	980	970 - 1,280	1,470
K: Overall width	mm	cabin 1,040 / canopy 980		1,470
L: Overall length	mm	3,790 [3,750]		4,540 [4,520]
M: Track height	mm	370		465 [455]
N: Engine cover height	mm	1,270		1,360 [1,350]
O: Horizontal distance to blade	mm	875	1,110	1,440
P: Blade height	mm	225		300
a: Max. digging reach (with short arm)	mm	3,970 [3,790]		4,830 [4,660]
b: Max. digging depth (with short arm)	mm	2,370 [2,160]		2,860 [2,680]
c: Max. cutting height (with short arm)	mm	3,660 [3,560]		4,550 [4,440]
d: Max. dumping height (with short arm)	mm	2,630 [2,530]		3,140 [3,020]
e: Min. swing radius (with short arm)	mm	1,590 [1,500]		2,050 [2,030]
f: Max. vertical wall (with short arm)	mm	2,010 [1,820]		2,370 [2,190]
g: Max. boom swing (with short arm)	mm	1,310 [1,230]		1,680 [1,660]
h: Blade bottom highest position (above ground)	mm	195 [195]	245 [245]	360
i: Blade bottom lowest position (under ground)	mm	205 [205]	225 [225]	310
j:Offset distance	mm	360 / 565		532 / 666
Bucket digging force SAE:PCSA	kN(kgf)	12.6 / 1,280 [12.6 / 1,280]		25.0 / 2,550
Bucket digging force ISO	kN(kgf)	16.0 / 1,630 [16.0 / 1,630]		21.1 / 2,150
Arm crowd force SAE:PCSA	kN(kgf)	8.5 / 870 [9.5 / 970]		14.6 / 1,490 [16.3 / 1,660]
Arm crowd force ISO	kN(kgf)	9.1 / 930 [10.3 / 1,050]		13.8 / 1,410 [15.3 / 1,560]

The figure in [ ] shows the machine equipped with short arm.

**HOKUETSU INDUSTRIES EUROPE B.V.**

Aalsmeerderdijk 156 unit J,1438 AX, OUDE MEER,  
The Netherlands  
Tel : +31-(0)20-646-2636 Fax : +31-(0)20-646-2191  
e-mail : info@hokuetsu.nl  
URL : http://www.hokuetsu.eu

**DISTRIBUTOR**

**AIRMAN® STANDARD RANGE**

**Mini EXCAVATOR**

**AX16-4  
AX18-4  
AX27-4**



Wide to be opened covers for quick maintenance (AX27-3 pictured)



AX18-4 equipped with a 3 pole canopy which can easily be removed by only taking out 7 bolts.

**Higher maintainability :**

- The wide to open engine and side covers allow easy access to the machines most important components, thus reducing valuable time needed to do maintenance.

**Improved productivity :**

- Three-pump hydraulic system for smooth combined operation.
- The new low-noise engine for less environmental impact boosts power and speed and meets the emission regulations EU stage III A.



The AX27-3 is equipped with an upward facing exhaust pipe to divert the exhaust gasses from surrounding places while working in urban areas.



The AX18-4 is equipped with an adjustable undercarriage and blade between 970 and 1280 mm to provide more stability during jobs.



New low noise engine complies with EU stage III A regulations.

#### Other features on the new AX-4 machines :

- Three-pump hydraulic system for smoother combined operation.
- The boom cylinder guard is now angled and ribbed for additional strength, protecting the boom cylinder from damage.
- Reinforced new thread pattern rubber shoes for more stable travel and greater durability.
- The cabin.
- The radiator and oil cooler are arranged side by side for easy cleaning and optimal heat balance.
- The neutral engine start system allows the engine to start only when the pilotcontrol shut-off is in the lock position.
- Easy to clean dustproof net protects the radiator from plugging.

#### STANDARD EQUIPMENT

##### ENGINE

- Water-separator for engine fuel
- Radiator reserve tank
- Electrical fuel feed pump
- Cartridge-type engine oil filter
- Fuel filter

##### UPPERSTRUCTURE

- Side view mirror
- Tool box

##### FRONT ATTACHMENTS

- Art bushing  
1.13m arm on AX16/18
- Extra piping  
1.35m arm on AX27 only

##### CAB

- ROPS/OPG cab
- Heater
- Window washer
- Defroster
- Reclining seat
- Suspension seat
- Seat belt
- Wrist rests
- Spare power supply
- Wiper
- Drink holder on AX27 only
- Electric horn
- Aux socket
- Floor mat
- Ashtray on AX27 only

##### HYDRAULIC SYSTEM

- Hydraulic pilot type control levers
- Pilot control shut-off lever with neutral engine start system
- Swing parking brake
- Travel parking brake
- Two-speed travel system
- Suction filter
- Full-flow filter
- Pilot filter
- Valve for extra piping

##### UNDERCARRIAGE

- 300mm rubber shoes

Standard equipment may vary by country, so please consult your dealer for details.

#### SPECIFICATIONS

Model name		AX16-4	AX18-4	AX27-4
Type of shoe / Type of roof		rubber / cabin		
Operating weight (canopy)		kg	1,770 (1,600)	1,930 (1,770)
Bucket capacity, without sidecutters / width		m <sup>3</sup> /mm	0.044 / 400	0.044 / 400
0.065 / 350				
<b>• Diesel Engine</b>				
Model (number of cylinders)			Yanmar 3TNV70 (3)	Kubota V1505 (4)
Type			Water-cooled, 4-cycle, direct injection, diesel engine	
Piston Displacement		cc	854	1,498
Rated output (ISO 9249) / at rpm / Maximum torque		kW/min <sup>-1</sup>	10.7 / 2,400	19.1 / 2,300
<b>• Hydraulic Devices</b>				
Main pumps (Variable Displacement axial piston type pump)			2x (19.2 L/min)	2x (32.2 L/min)
Third pump (gear type)			1x (12.5 L/min)	1x (18.4 L/min)
Pilot pump (gear type)			1x (6.5 L/min)	1x (6.21 L/min)
Auxiliary maximum oil flow		L/min	31.7	50.6
Swing motor			1 gear pump	
Travel motor			2x 2 speed variable displacement axial piston motor	
Relief Valve Settings	implement circuit / Travel circuit / Aux. circuit	MPa	20.6 (210 kgf/cm <sup>2</sup> )	22.6 (230 kgf/cm <sup>2</sup> )
	swing circuit	MPa	11.3 (115 kgf/cm <sup>2</sup> )	18.6 (190 kgf/cm <sup>2</sup> )
	pilot circuit	MPa	3.9 (40 kgf/cm <sup>2</sup> )	
<b>• Noise level</b>				
Noise level (LwA)(2000/14/EC)		dB(A)	93	94
Noise level (LpA)(ISO6396)		dB(A)	78	80
<b>• Max.Digging Force</b>				
Arm crowd force with long arm mounted (std. Arm) - ISO -		kN	9.1 (10.3)	14.6 (16.3)
Bucket digging force		kN	16.0 (16.0)	25.0 (25.0)
<b>• Speed (2 speed system)</b>				
Max travel speed on rubber shoes (slow) / Max. Trac. Force		km/h	0 - 4.2 (0 - 2.4) / 5.6 kN	0 - 4.4 (0 - 2.8) / 20.1 kN
Swing speed (swing torque)		min <sup>-1</sup> (rpm)	8.9 (2.61 kN.m)	9.4 (3.83 kN.m)
Gradeability degree		%	58 (30 degrees) continuous	
<b>• Undercarriage</b>				
Shoe width		mm	230	300
Ground pressure (equipped with long.arm)		kPa	30.5 (27.6)	30.8 (28.2)
Ground clearance (excluding track shoe lug)		mm	235 (165)	300 (290)
<b>• Dimensions for Transportation</b>				
(A) Overall Length (with short arm)		mm	3,790 (3,750)	4,540 (4,520)
(E) Undercarriage Length		mm	1,470	1,570
(B) Undercarriage width		mm	980	970 - 1,280
(C) Overall Height (canopy)		mm	2,380 (2,340)	2,390
<b>• Service refill Capacities</b>				
Fuel tank		liter	22.0	47.0
Hydraulic tank (Hydraulic system)		liter	15.5 (30.0)	32.4 (56.0)
<b>• Options</b>				
Std arm (long arm dimension)		m	0.93 (1.13)	1.17 (1.35)
Steel shoes		mm	Not available	300